

# 3D-IW8, Inteliwasher



Product video is available  
on the website

Inteliwasher **3D-IW8** series microplate washer is designed for washing various types of standard 96-well microtitre plates, microstrips as well as microarrays on FastFRAME (rectangular well shape). It is suitable for washing wells with different bottom shapes: flat, U-shape and V-shape. The unit is fully programmable ensuring multi-step solution ripening, aspiration (aspiration, combination of aspiration/liquid dispensing and soaking, as well as soaking cycle during a particular period of time). Dispense system of liquid dosage for each channel separately.

## The unit provides:

- Washing mode
- Rinsing mode
- Mixing mode
- Single point, two point, circular (circle or rectangular path) aspiration
- Possibility of additional solution mixing during time gap between two work cycles
- Possibility to use microtest plates by different manufacturers, ensured by automated plate set up (adjusting to different depths of plate wells)
- Round-bottom plate and strip washing mode
- Possibility of user-defined programs with adjustable parameters

## Catalogue number:

<b>3D-IW8</b>	BS-060102-AAI
<b>4CHW Logger</b>	BS-060102-AK





The unit has 50 programs divided into 5 following aspiration categories (see figure below):

- 1 **Type 1** (1.0–1.9) **IPF96 U/V** is intended for round and V-shape immunoplates, 1 point aspiration.
- 2 **Type 2** (2.0–2.9) **IPF96 FLAT-2** is intended for flat-bottom shape immunoplates, 2 point aspiration.
- 3 **Type 3** (3.0–3.9) **IPF96 FLAT-C** is intended for rectangular shape immunoplates, full-circle aspiration direction.
- 4 **Type 4** (4.0–4.9) **FastFRAME-2** is intended for multi-slide plate\* with rectangular wells.
- 5 **Type 5** (5.0–5.9) **FastFRAME-C** is intended for multi-slide\* plate with rectangular wells.

\* — The **FastFRAME** (Schleicher&Shuel) multi-slide plate or analog plate of another manufacturer, that is compatible with standard 25×76 mm (1×3 inch) glass slides.

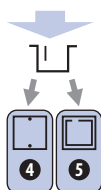
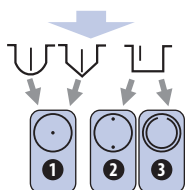
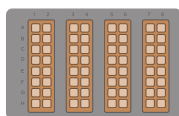
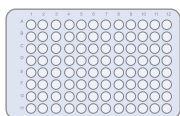

## Specifications:

Minimum dispense volume	25 µl
Maximum dispense volume	1600 µl
Dispense increment	25 µl
Dispensing accuracy	±2%
Allowed residual liquid volume in plate well, not more	2 µl
Number of wells washed simultaneously	8
Number of washing cycles	1–15
Aspiration time	1–3 sec
Final aspiration time	1–3 sec
Aspiration/dispensing speed	3 levels
Max. number of channels in a program	2
Choice of 3 washing liquid bottles	
Soaking time	0–300 sec (increment 10 sec)
Shaking time	0–150 sec (increment 5 sec)
Number of washed rows	1 – 12
Time of one plate wash (300 µl), not more	65 sec
Number of programs	50
Plate platform and washing head movement	automated
Indication of operation modes	LCD, 8-line
Dimensions (W×D×H)	375×345×180 mm
Weight with accessories	10.5 kg
External power supply	DC 12 V, 4.16 A
Consumed power, not more	60 W

The unit is designed for use in closed laboratory rooms at temperatures from +10°C to +35°C and relative humidity up to 80% at +25°C decreasing linearly to 50% relative humidity at 35°C.

Logger dimensions (W×D×H)	267×252×97 mm
Logger weight, not more	3 kg

4-channel washing solution weight logger, **4 CHW Logger** provides automatic control of rinsing solution and waste volumes. The washer shows remaining volume for each bottle as percentage and gives a warning message in case of low solution volume or full waste bottle when 4CHW Logger is connected.